

# INSTALLATION INSTRUCTIONS & PARTS DIAGRAM

Intermediate Hardware

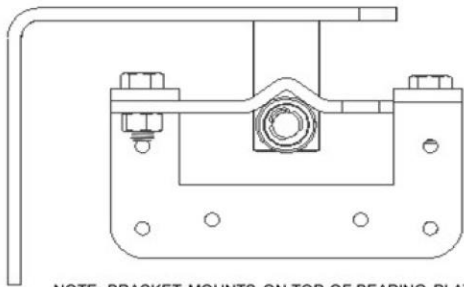

NOTE: BRACKET MOUNTS ON TOP OF BEARING PLATE

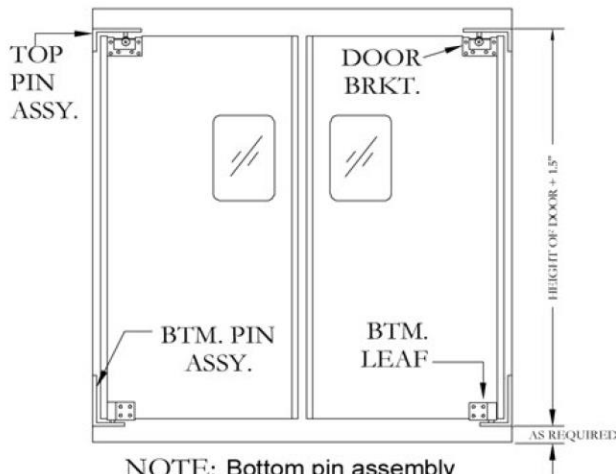

NOTE: Bottom pin assembly must be secured to floor.

JAMBS MUST BE SQUARE AND PLUMB  
A MINIMUM OF 3-1/2 INCH WIDE JAMBS  
REQUIRED TO MOUNT HARDWARE

1. Measure width and height of framed opening and compare with dimensions given at time of ordering. (This model was cut to the dimensions given by the customer and is not adaptable to fit into a different size of opening.)
2. Position bottom pin assembly in desired location off of floor and center on side jamb. Secure to jamb using (4) screws supplied.
3. Top pin can be located by using the height of the door plus (+) 1-1/2 inches. This dimension is for the overall height of the hardware. Secure to side jamb using (4) screws supplied.
4. Slip door over bottom pin and lift slightly to slide door bracket over bearing plate. Line up holes and insert bolts supplied. Partially install lock nuts, move door to closed position and secure lock nuts.
5. To install covers, remove the (2) center bolts / nuts in top door bracket. Position both covers and replace the (2) center bolts / nuts back into original holes.

NOTE: HOLLOW METAL JAMBS DRILL 7/32 PILOT HOLE FOR 9 GA. AND THINNER MATERIAL

- Top Pin Assy
- (4) 1/4" - 20 x 1" phil. flt. hd. thread cutting screws
- (4) #14 - 1-1/2" phil. flt. hd. sheet metal / wood screws
- Bearing Plate with (2) 5/16 - 18 screws, (2) 5/16 - 18 lock nuts
- 3/8" Axle
- (2) Rollers
- Klipring
- (2) Covers, fasteners secured to door
- Bottom Pin Assy (4)

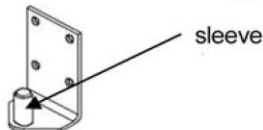
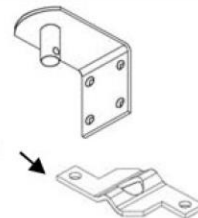

**Strip-Curtains.com**