

Strip-Curtains.com

Spring Loaded

All Season Roll-Up Doors

IN-JAMB MOUNTING METHOD INSTALLATION INSTRUCTIONS



READ THIS FIRST

Carefully examine the crate(s) for damage before opening. If the carton is damaged, immediately notify shipping company. Open the carton(s) and remove all protective packaging. Retain the shipping carton(s) until the unit(s) is installed and properly operating. Strip-Curtains.com is not responsible for delayed or late claims.

Serial No: _____ Model #: _____ Date Purchased: _____

Warning

To Reduce the Risk of Injury, Observe the Following:

- Use this unit only in the manner intended by the manufacturer. If you have any questions, contact the manufacturer.
- Installation work must be done by a qualified person(s) in accordance with all applicable codes and standards.
- When cutting or drilling into wall or ceiling, do not damage electrical wiring and other hidden utilities.

Read and Save These Instructions

Please read the “READ THIS FIRST” note on the front cover of this manual before proceeding.

TYPES OF DOORS



There are a variety of doors used at both industrial and commercial facilities. Each has its specific opening/closing mechanism. This Screen-Pro unit has been shipped with hardware to accommodate an In-Jamb Mounting Method. It should be mounted inside a plain doorway opening using the door jambs to attach the Guide Tracks.

–IMPORTANT–

This Screen-Pro model has been designed to fit inside a doorway opening that has an 8" jamb width or larger.

SCREEN-PRO COMPONENTS

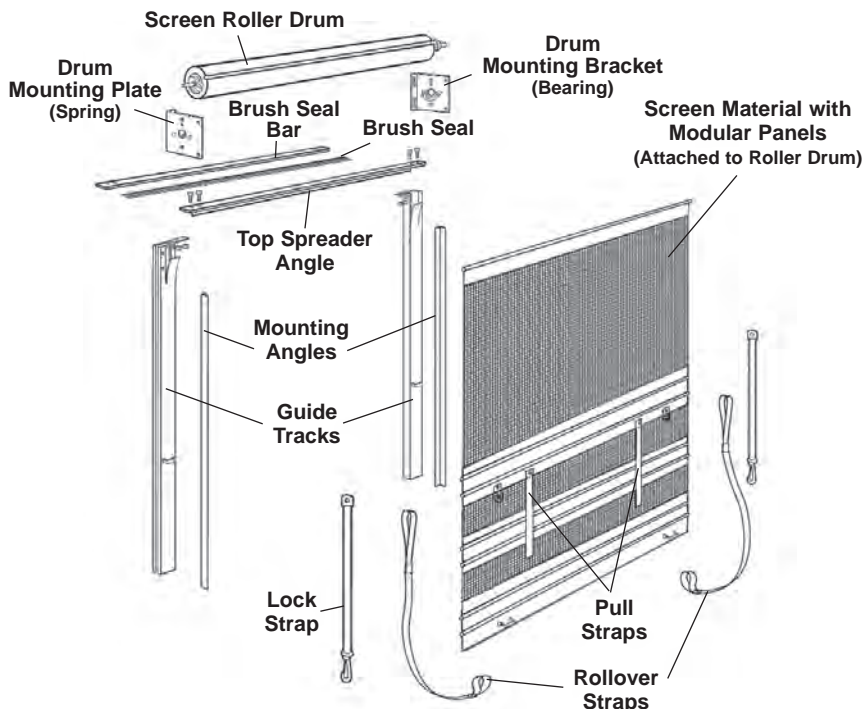

REQUIRED TOOLS

It is recommended that two people install the door together.

The following tools will be needed for installation:

- Carpenter's Level (Min. 4' Length)
- Carpenter's Square
- Hammer Drill
- Masonry Drill Bit (For $\frac{3}{8}$ " Diameter Anchors)
- $\frac{3}{8}$ " Diameter and Various Wall Anchors
- Assorted Shim Stock
- Socket and Wrench Set
- Hand Tools
- Four Bar Clamps (36" Long)
- Two Ladders
- Forklift (Supplied by Dealer or Customer)

STEP 1

Lay the basic components in front of the doorway opening.

Using work horses will make the assembly process easier although it is not essential. Place the Guide Tracks with the Guide Flare facing up.

STEP 2

Slide the Brush Seal into the edge groove of the Brush Seal Bar.

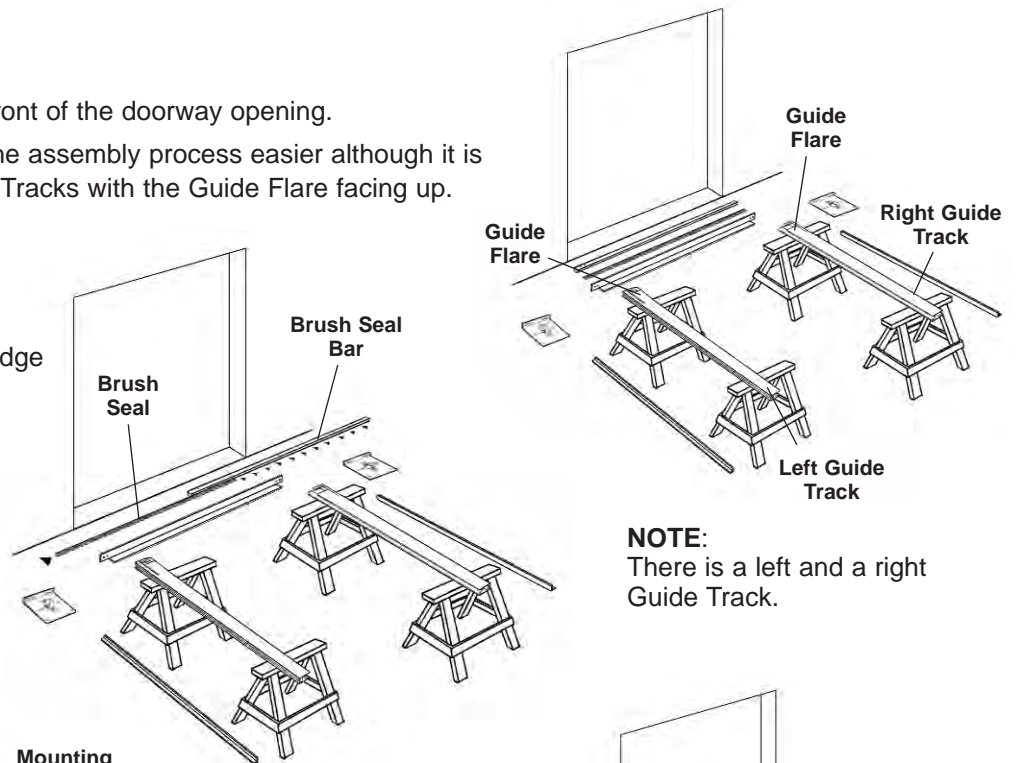

NOTE:

There is a left and a right Guide Track.

STEP 3

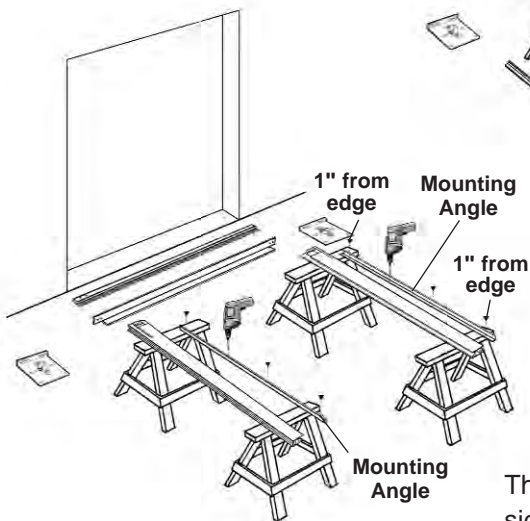

Drill 4 mounting holes on one side of each Mounting Angle. The holes should be placed approximately 1" from each edge and equally spaced between those holes.

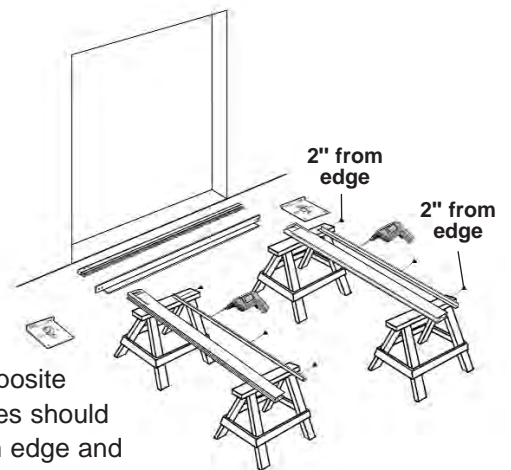

Then drill 4 mounting holes on the opposite side of each Mounting Angle. The holes should be placed approximately 2" from each edge and equally spaced between those holes.

STEP 4

Place each Mounting Angle on the outer edge of each Guide Track. The bottom of the Mounting Angle should be flush with the bottom of the Guide Track (See illustration).

Then mark each hole.

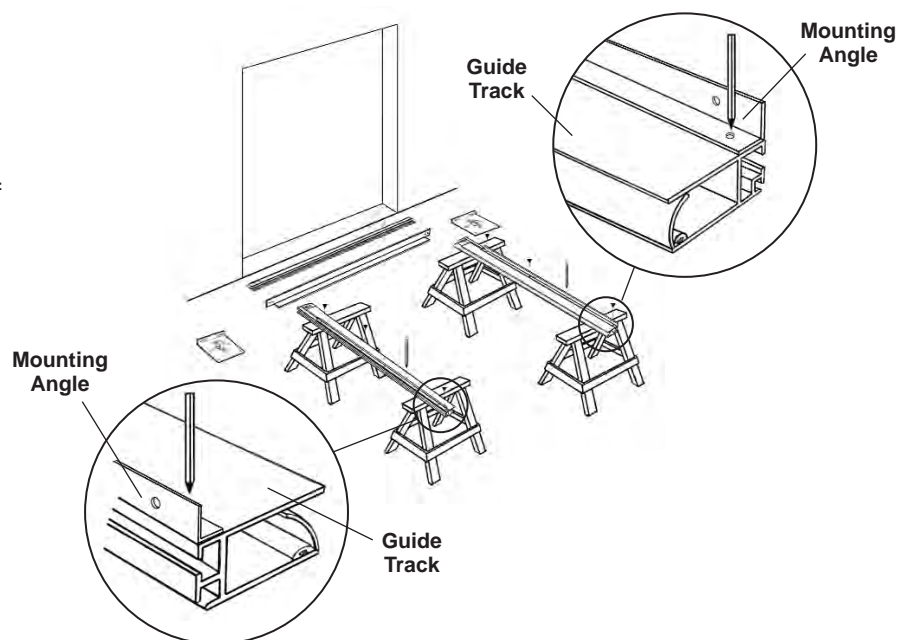

STEP 5

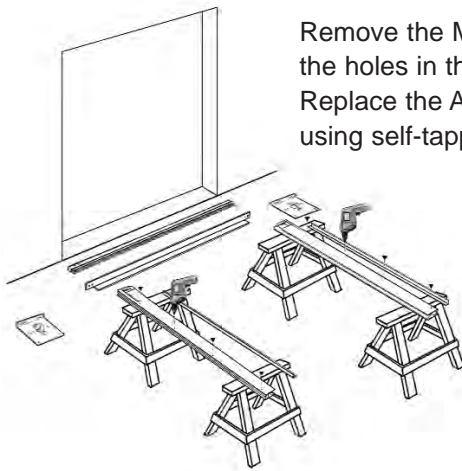

Remove the Mounting Angles and drill the holes in the Guide Tracks. Replace the Angles and secure them using self-tapping sheet metal screws.

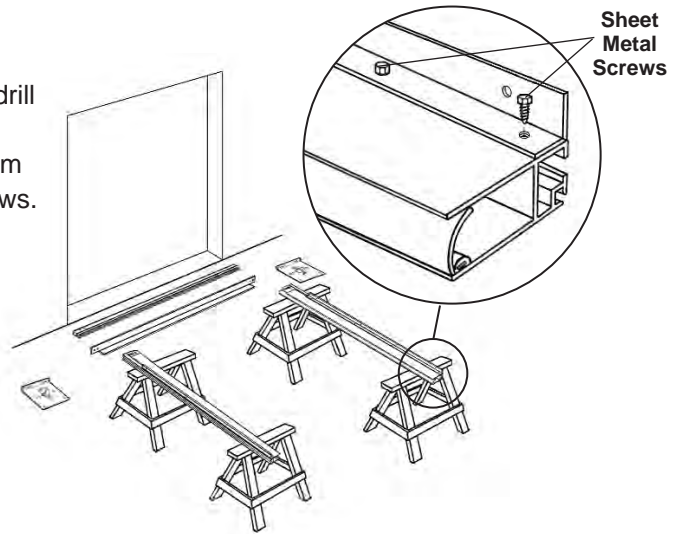

STEP 6

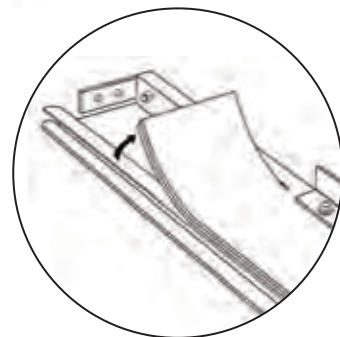
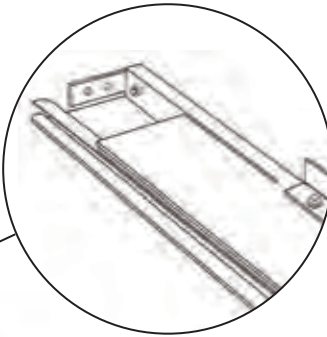
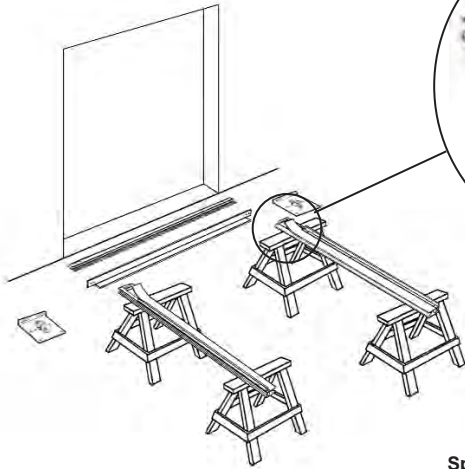

IMPORTANT

The Guide Track Flare Plate ships flat and must be bent out 1 1/2" before any assembling takes place.

STEP 7

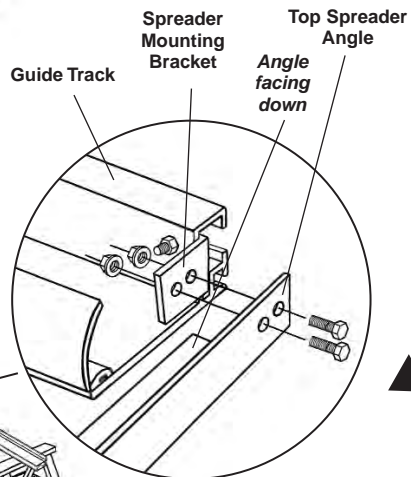
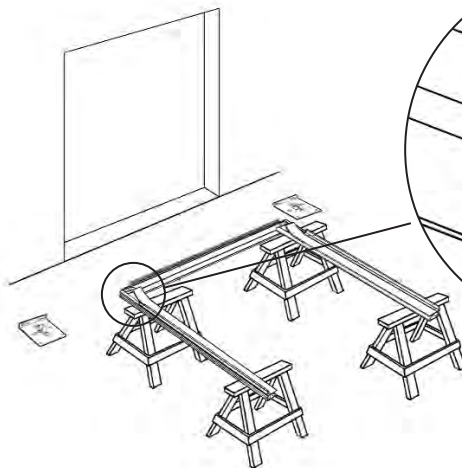

Attach the Top Spreader Angle to the top of the Guide Track using the Spreader Mounting Bracket. Make sure the back of the Spreader Angle is facing down and toward the wall. Use 2 bolts and flange nuts on each side to secure all the components..

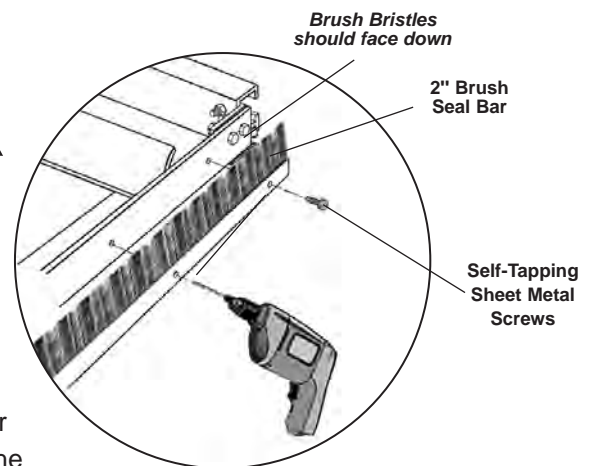

With the brush bristles facing down, center the 2" Brush Seal Bar on top of the Spreader Angle and mark the pre-drilled holes on the Spreader Bracket. Remove the brush and drill the holes. Reposition the Brush and use the supplied Self-Tapping Sheet Metal Screws to attach the Brush Bars to the Spreader Bracket

STEP 8

Attach a Drum Mounting Plate to the top of each Track Guide using 5/16" x 1-1/4" bolts with flange nuts. The square cradle (spring side) goes on the left and the round cradle (bearing side) is on the right.

IMPORTANT: Use the bottom hole of each set of holes.

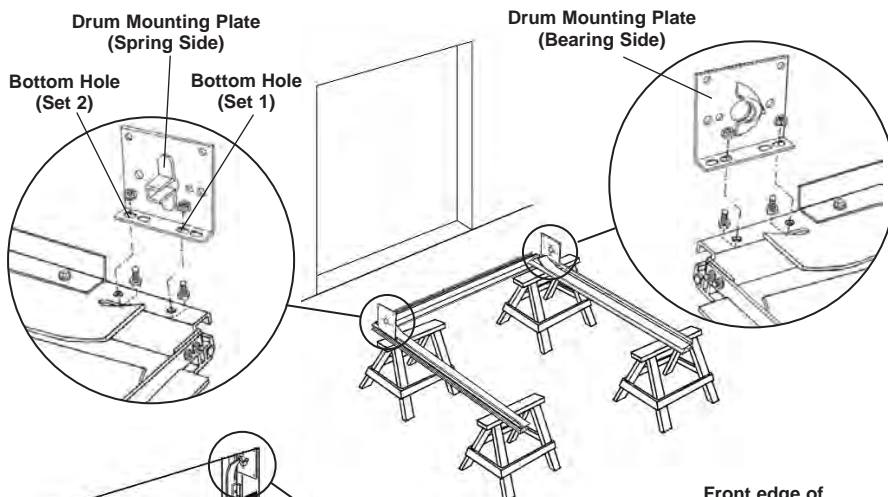

STEP 9

Place the assembly into the doorway opening. The bottom of each Guide Track should be resting on the floor. The front edge of the Drum Mounting Plates should be flush with the front edge of the door jamb tight against the header. Make sure the assembly is plumb. Mark the 4 mounting holes on each of the jamb.

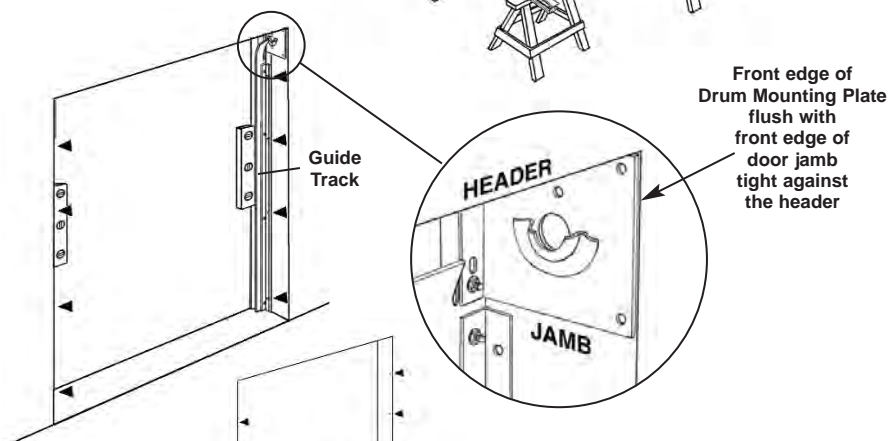

STEP 10

Remove the assembly and drill the holes. If the jamb is wood, a lag screw with washer is all that is needed. If the jamb is concrete or steel & concrete, a wall anchor should be placed in each hole.

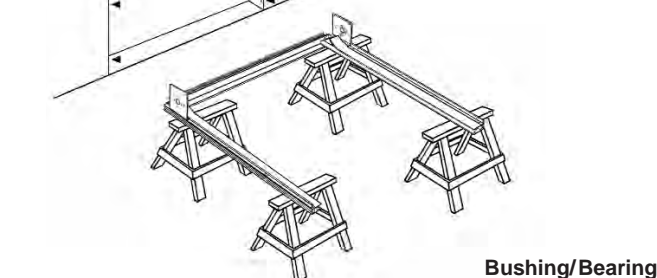

WARNING

The spring tension for the Roller Tube is pre-set at the factory and is shipped with the Lock Plate in place. **DO NOT** remove the plate until the assembly process is completed. Also **DO NOT** remove the Roll Ties until the Roll Tube is secured to both End Plates.

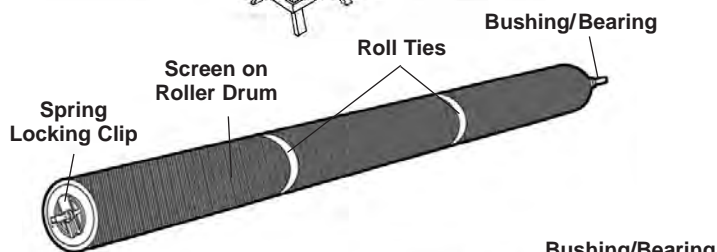

STEP 11

Stand the assembled unit upright and lean it against a wall. Place the Screen Roller Drum into each Drum Mounting Plate.

The Spring Locking Clip (square shaft) should be to the left and the Bushing/Bearing (round shaft) to the right.

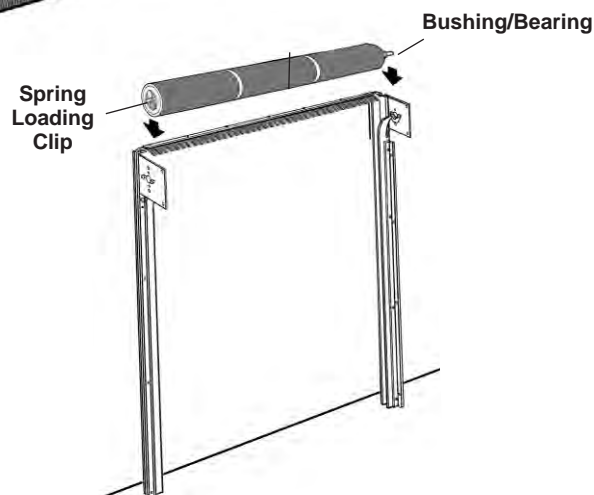

The Bottom Edge of the Screen facing down.

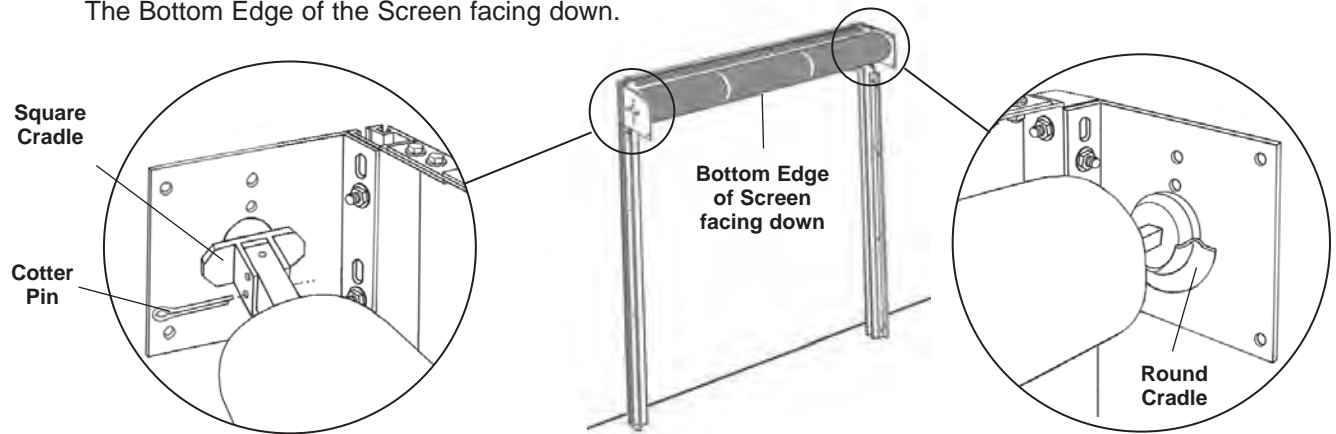

Once the shaft is in both cradles, place a Cotter Pin through the square shaft and cradle to secure it (left side).

STEP 12

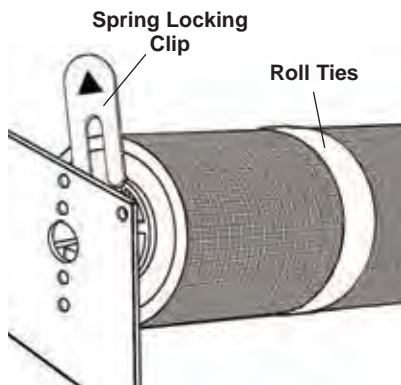

With the Screen Roller Drum in place, remove the Spring Locking Clip.

Then carefully cut the Roll Ties without cutting the screen. Slip the bottom edge of the screen into the Guide Tracks. Place the leading edge in front of the Rubber Gasket to create a seal.

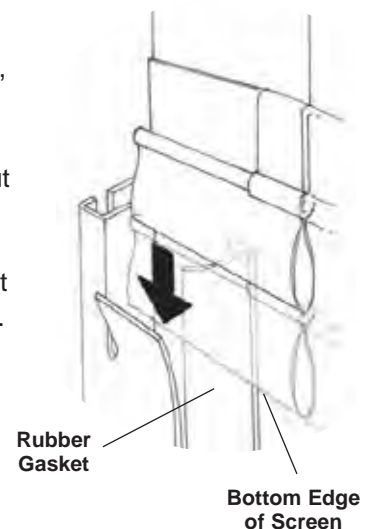

STEP 13

Reposition the assembly in the doorway opening and fasten it securely against the jambs with lag screws and washers.

Check the door movement. If the spring needs more tension, follow the procedure on page 8, entitled "ADDING TENSION TO THE SPRING."

STEP 14

After all adjustments are made the the Rear Spreader Plate can be attached. It is fastened to the back (exterior) of the Guide Tracks. Use 4 self-tapping screws.

SIDE VIEW OF SCREEN BARREL & DOOR OPENING

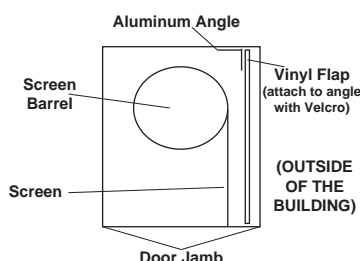

Rear Vinyl Cover

1. Rear Vinyl Cover will attach behind the screen barrel when standing inside the building looking out.
2. Mount aluminum angle to header and then attach vinyl flap using the hook/loop provided.
3. If you ordered the Aluminum Rear Spreader upgrade, then you will only need the 4 tek screws to fasten the Aluminum Spreader to the back side of the guide tracks.

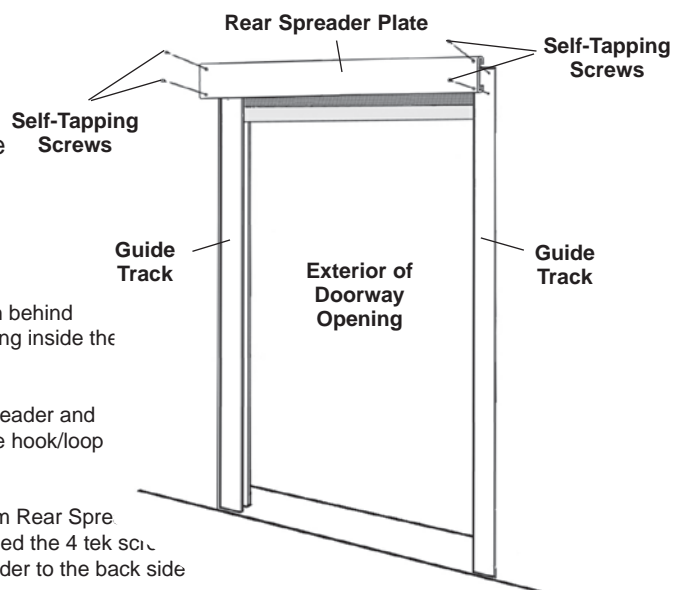

STEP 15

STRAP PLACEMENT

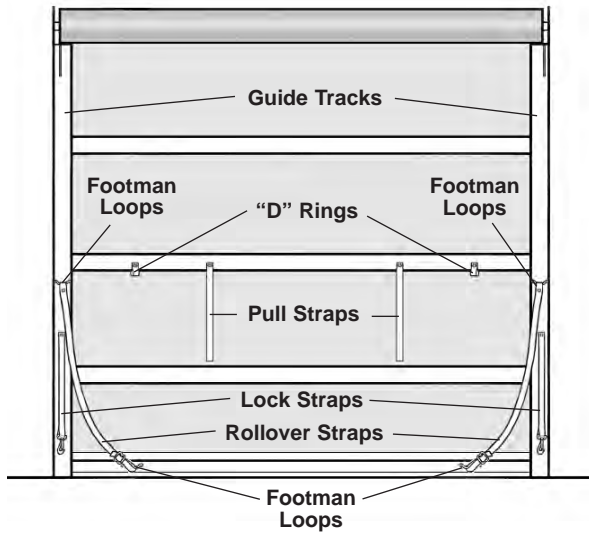

The final steps are attaching the Rollover Straps and Lock Down Straps.

NOTE: The "D" Rings, Pull Straps and Slide Handles are attached at the factory. Also, one end of the Rollover Straps is attached to the bottom of the screen.

Pull the screen down to release the 2 Rollover Straps. A Slide is attached to each strap. Make sure the straps are laying flat and not twisted.

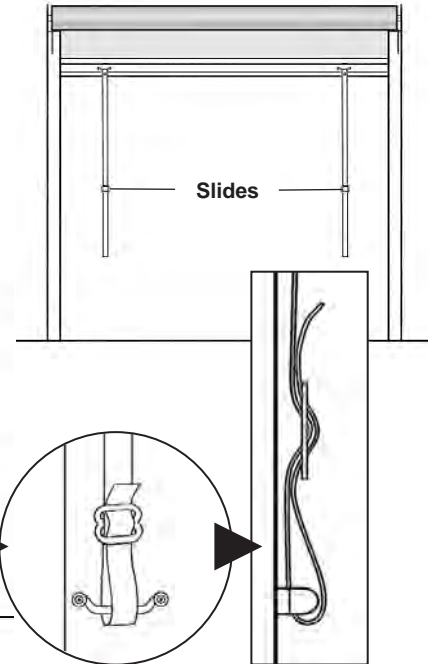

Feed the strap through the Footman Loop that has been pre-attached to the Guide Track. Then take the strap back through the slide as shown in the illustration to the right. Adjust the strap so it is taut when the door is in the open position.

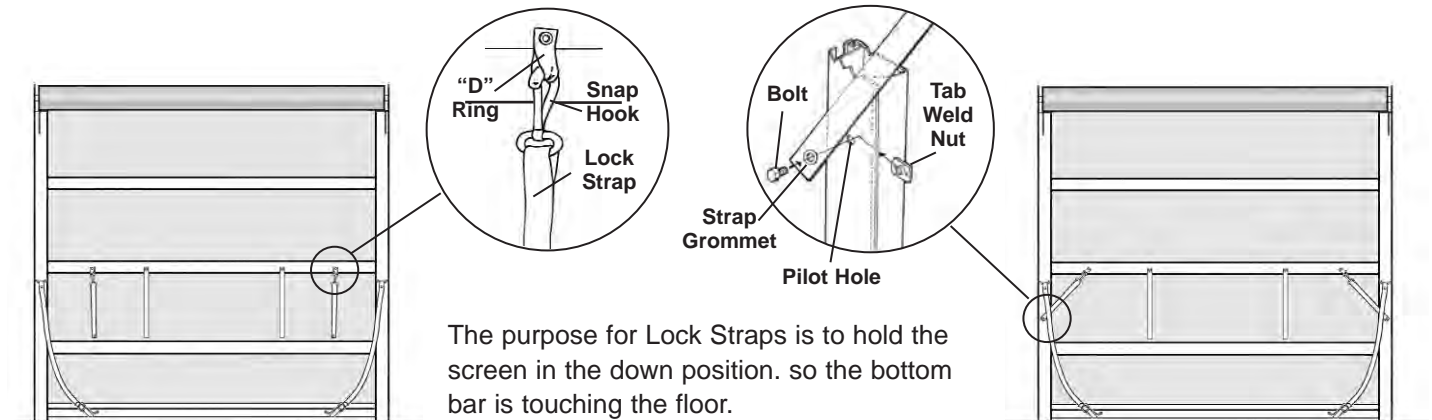
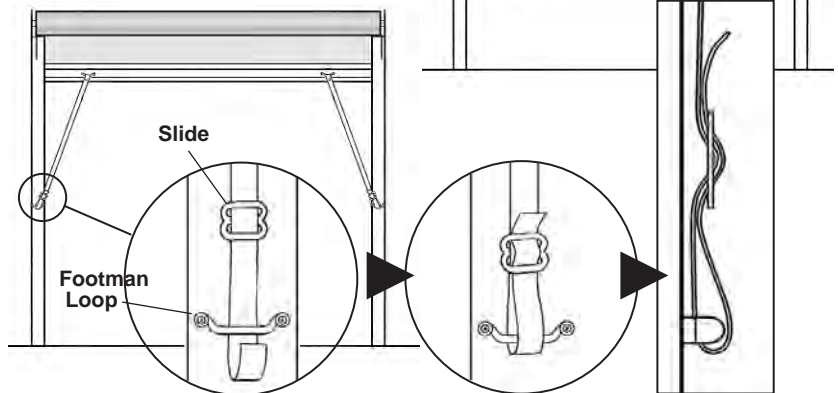

The purpose for Lock Straps is to hold the screen in the down position. so the bottom bar is touching the floor.

Once the Rollover Straps are set, pull the screen to the down position. Take the short Lock Straps with the Snap Hooks on one end and snap the hook into the "D" Ring. Take the other end of the strap and pull it at a diagonal so the Strap Grommet is centered on the front of the Guide Track. Mark the hole. **IMPORTANT: Place the screen in the open position.** Drill the Pilot Hole for the Tab Weld Nut (supplied). Next, place the screen in the down position. Finally, with the Weld Nut on the inside of the Guide Track, secure the strap with the Bolt through the Strap Rivet.

ADDING TENSION TO THE SPRING

If after testing the door movement, the spring needs more tension, the following procedure should be taken. First, remove the assembly from the doorway opening.

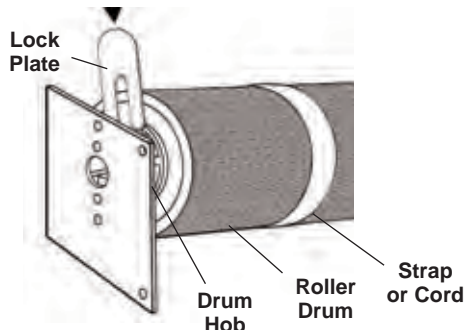

Second, wind up the screen so it is completely on the Roller Drum. Using a strap or cord, secure the screen so it is unable to unwind. Place the Lock Plate into the Drum Hub.

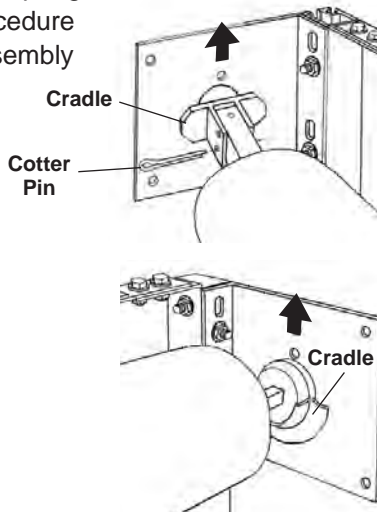

Next, remove the Cotter Pin on the left side and lift the Screen Roller Drum out of the Drum Bracket Cradles.

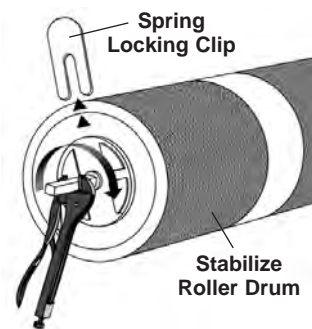

Then, with the Roller Drum totally stabilized, lock a Vise Grip onto the shaft. Keeping everything in tension, remove the Lock Plate. Turn the shaft clockwise one complete turn and replace the Spring Locking Clip.

Finally, reattach the Screen Roller Drum to the Drum Mounting Plates (See Step 11, Page 7) and continue the installation through Step 15.

NOTES