

INSTALLATION INSTRUCTIONS & PARTS DIAGRAM

INTERMEDIATE HARDWARE

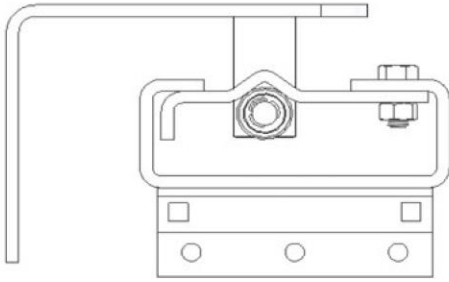

JAMBS MUST BE SQUARE AND PLUMB
A MINIMUM OF 3-1/2 INCH WIDE JAMBS
REQUIRED TO MOUNT HARDWARE

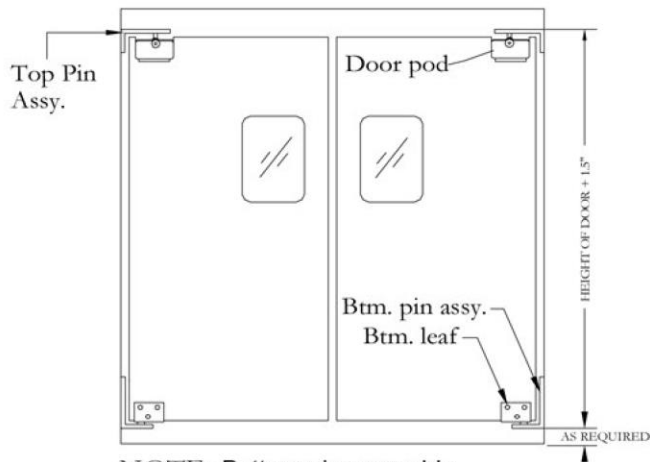

NOTE: Bottom pin assembly must be secured to floor.

1. Measure width and height of framed opening and compare with dimensions given at time of ordering. (This model was cut to the dimensions given by the customer and is not adaptable to fit into a different size of opening.)
2. Position bottom pin assembly in the desired location off of floor and center on side jamb. Secure to jamb using (4) screws supplied.
3. Top pin assembly can be located by using the height of the door plus (+) 1-3/4". This dimension is for the overall height of the hardware. Secure top pin to side jamb using (4) screws supplied.
4. Slip door over bottom pin and lift slightly to slide door pod over bearing plate. Line up holes and insert bolts supplied. Partially install lock nuts, move door to closed position and secure lock nuts.
5. Install covers and secure. (4) screws supplied per door.

NOTE: HOLLOW METAL JAMBS DRILL 7/32 PILOT HOLE FOR 9 GA. AND THINNER MATERIAL

-- Top Pin Assy

- (4) 1/4" - 20 x 1" phil. flt hd. thread cutting screws
- (4) #14 - 1-1/2" phil. flt hd. sheet metal / wood screws

-- Bearing Plate with (2) 5/16 - 18 screws, (2) 5/16 - 18 lock nuts

-- 3/8" Axle

-- (2) Rollers

-- Klipring

-- (2) Aluminum Covers, (4) screws

-- (2) SS Covers, (4) screws

-- (2) ABS Covers, (4) screws

-- Bottom Pin Assy (4) of each fastener listed under

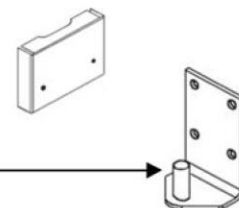
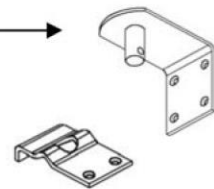

Strip-Curtains.com